

Inbouwcontactdoos TM

Bestelnr. 24643



- schroefklemmen
- hittebestendig binnenwerk
- vernikkelde contacten
- 20° hoek
- (Vorm BS)

Technische informatie

| | |
|-------------------|--|
| Ampère | 16 A |
| Polen | 5 p |
| Voltage | 50-500 V |
| Uurstand | 2 h |
| Hertz | 300-500 Hz |
| Aansluittechniek | schroefklemmen |
| Contacten | hittebestendig binnenwerk, vernikkelde contacten |
| Beschermingsgraad | IP67 |
| Flens | 85x85 mm |
| Bevestigingsgaten | 70x70 mm |
| Hoek | 20 ° |
| Gewicht | 235 g |
| Certificeringen | VDE |

Tekeningen

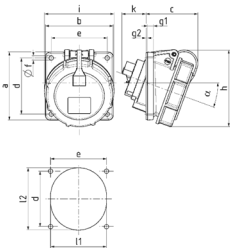

| Tekening 1 MB 474 | Amp. Polen | 16 | | 32 | | 63 |
|---|---------------|-----|-----|-----|-----|-------|
| | | 3 | 5 | 3 | 5 | 3/4/5 |
| Maten in mm | a | 85 | 85 | 85 | 85 | 114 |
| | b | 85 | 85 | 85 | 85 | 114 |
| | c | 66 | 65 | 67 | 78 | 98 |
| | d | 70 | 70 | 70 | 70 | 90 |
| | e | 70 | 70 | 70 | 70 | 90 |
| | f | 5,5 | 5,5 | 5,5 | 5,5 | 6,5 |
| | g | 8 | 8 | 8 | 8 | 12 |
| | g.1 | 2 | 2 | 2 | 2 | 2 |
| | h | 89 | 97 | 101 | 108 | 135 |
| | i | 70 | 87 | 94 | 101 | 113 |
| | k | 40 | 35 | 54 | 43 | 62 |
| | l min. | 57 | 70 | 78 | 78 | 92 |
| | l max. | 78 | 78 | 78 | 78 | 105 |
| | o | 20 | 20 | 20 | 20 | 15 |
| Kabelaansluiting van/tot mm ² | | 1,5 | 1,5 | 2,5 | 2,5 | 6 |
| | | -4 | -4 | -10 | -10 | -25 |