

Toestelcontactstop

Bestelnr. 392

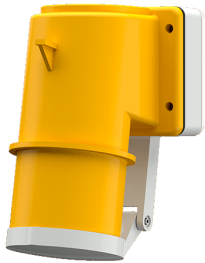

- schroefklemmen
- met klapdeksel

Technische informatie

| | |
|-------------------|----------------|
| Ampère | 16 A |
| Polen | 4 p |
| Voltage | 110 V |
| Uurstand | 4 h |
| Hertz | 50-60 Hz |
| Aansluittechniek | schroefklemmen |
| Contacten | standaard |
| Beschermingsgraad | IP 44 |
| Gewicht | 260 g |
| Certificeringen | EAC |

Tekeningen

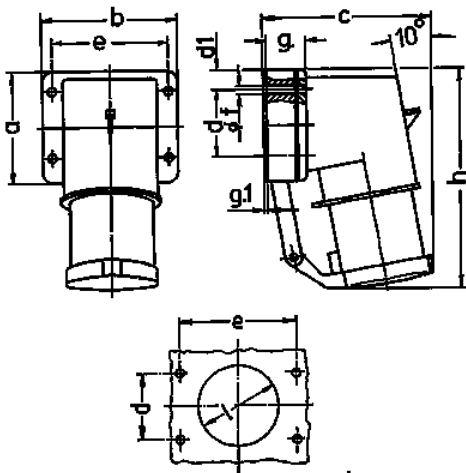

| Tekening | Amp. Polen | 16 | | 32 | | |
|-------------------------|---------------|------|------|-----|-----|-----|
| | | 4 | 5 | 3 | 4 | 5 |
| 2 MB 43 | | | | | | |
| Maten in mm | a | 85 | 85 | 75 | 75 | 75 |
| | b | 85 | 85 | 90 | 90 | 90 |
| | c | 104 | 106 | 115 | 115 | 117 |
| | d | 64 | 64 | 45 | 45 | 45 |
| | d1 | 10 | 10 | 13 | 13 | 13 |
| | e | 64 | 64 | 78 | 78 | 78 |
| | f | 5,5 | 5,5 | 5,5 | 5,5 | 5,5 |
| | g | 27 | 27 | 27 | 27 | 27 |
| | g.1 | 2 | 2 | 1 | 1 | 1 |
| | h | 140 | 140 | 150 | 150 | 150 |
| | l | 50 | 50 | 55 | 55 | 55 |
| Kabelaansluiting | | | | | | |
| van/tot mm² | | 1 | 1 | 2,5 | 2,5 | 2,5 |
| | | -2,5 | -2,5 | -6 | -6 | -6 |